

THESE DRAWINGS AND SPECIFICATIONS ARE THE PROPERTY OF JBL. INCORPORATED. THEY ARE ISSUED IN STRICT CONFIDENCE AND SHALL NOT BE REPRODUCED OR USED AS THE BASIS FOR MANUFACTURE OR REPAIRS WITHOUT WRITTEN PERMISSION.

REVISIONS			
CHG	INTR	DESCRIPTION	DATE
30258	A	RELEASE TO MARKETING	3/11/2004
38767	B	ADDED DOCUMENT NUMBER	AR

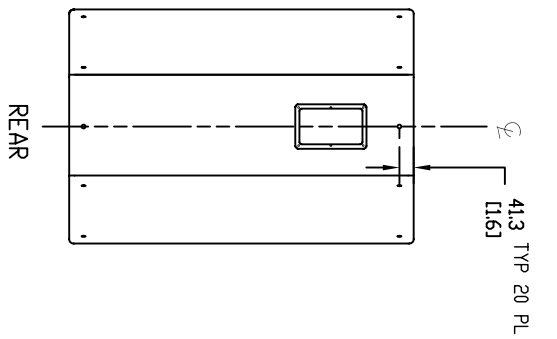
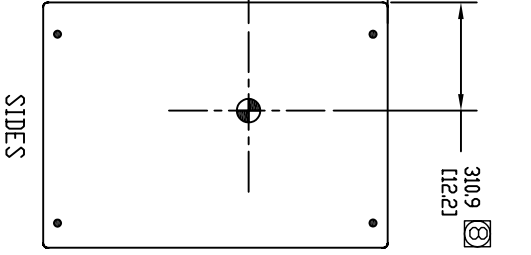
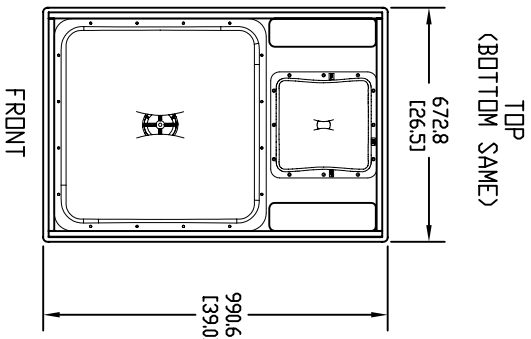
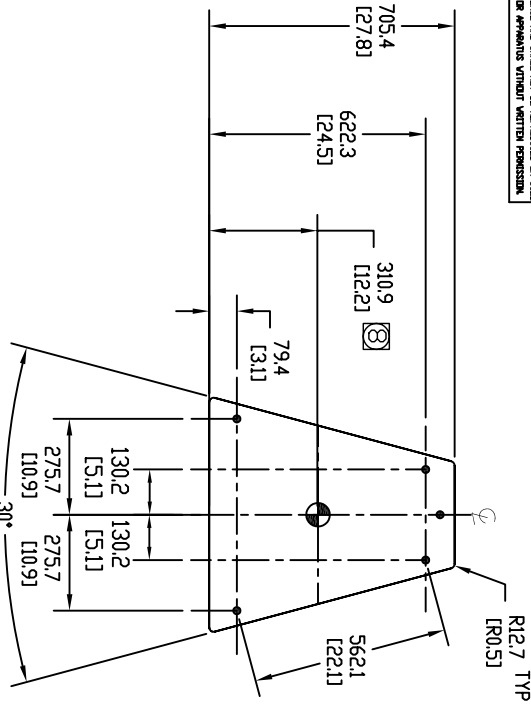

1. COMPONENTS: LF – 2X 2206H; MF – 1X CMCD82H; HF – 1X 2431H
2. INPUT CONNECTORS: 8 TERMINAL BARRIER STRIP AND 1X NEUTRK NL8 SPEAKON.
3. GRILL: 16 GA. PERFORATED CRS, POWDERCOATED BLACK, BLACK FOAM BACKING.
4. MATERIALS: 16MM (5/8") FINISH BIRCH PLYWOOD.
5. FINISH: BLACK DURAFLEX
6. SUSPENSION POINTS: "••" 20 TOTAL; 5 EA TOP AND BOTTOM, 4 EA SIDE, 2 REAR; M10 THREAD PATTERN.
7. WEIGHT: 77.3 kg (170 LBS)

NOTES: (UNLESS OTHERWISE SPECIFIED)

TOLERANCES			
UNLESS OTHERWISE SPECIFIED			
XXX ± .003 INCH			
XX ± .005 INCH			
ANGULAR TOLERANCE OF 0°±30°			
FRACTIONAL DIMENSIONS ± 1/32			
DIMENSIONS ARE IN INCHES			
ALL DIMENSIONS ARE FINISHED DIMENSIONS			
DO NOT SCALE DRAWING			
JBL PROFESSIONAL		JBL	
A Harman International Company		A Harman International Company	
Northridge, California 91329 U.S.A.		Northridge, California 91329 U.S.A.	
TITLE		PD5322/64	
SIZE		A	
DRAWING NO.		444323	
REV		B	
SCALE		NTS	
SHEET		1 OF 1	